

City of Hastings

2011 Infrastructure Improvements Program
Proposed Improvement Project Area #2

2011 Infrastructure Improvements

Preliminary Design Information

Area 2

North Frontage Road

Street Improvements

<u>Segment</u>	<u>Existing Width</u>	<u>Proposed Width</u>
Pleasant Dr to 500 ft west	± 40'	± 40'

- Spot replacement of concrete curb & gutter.
- Replacement of the blacktop street surface with mill & overlay or full-depth reclamation.
- No new sidewalk segments are proposed.

Utility Improvements

- Replacement of existing storm sewer and sanitary sewer castings.

Whispering Court

Street Improvements

<u>Segment</u>	<u>Existing Width</u>	<u>Proposed Width</u>
Whispering Ln to end of cul-de-sac	± 36'	± 36'

- Spot replacement of concrete curb & gutter
- Replacement of the blacktop street surface with mill & overlay or full-depth reclamation.
- No new sidewalk segments are proposed.

Utility Improvements

- Spot replacement of existing sanitary sewer services (and water services that are adjacent).
- Replacement of existing storm sewer and sanitary sewer castings.

Whispering Lane

Street Improvements

<u>Segment</u>	<u>Existing Width</u>	<u>Proposed Width</u>
4 th St W to Pleasant Dr	± 36'	± 36'

- Spot replacement of concrete curb & gutter
- Replacement of the blacktop street surface with mill & overlay or full-depth reclamation.
- No new sidewalk segments are proposed.

Utility Improvements

- Spot replacement of existing sanitary sewer services (and water services that are adjacent).
- Replacement of existing storm sewer and sanitary sewer castings.

**CITY OF
HASTINGS
CITY HALL**

101 4th Street East
Hastings, MN 55033-1955
651-480-2350
Fax: 651-437-7082
www.ci.hastings.mn.us
cityhall@ci.hastings.mn.us

Department of
Building Safety
651-480-2342

Engineering/
Planning/HRA/HPC
651-480-2334

Public Works
1225 Progress Drive
651-480-6185

Parks & Recreation
920 10th Street West
651-480-6175

Police
150 3rd Street East
651-480-2300

Fire
115 5th Street West
651-480-6150

Civic Arena
2801 Red Wing Boulevard
651-480-6159

Aquatic Center
901 Maple Street
651-480-2392

February 2011

IMPORTANT NOTICE - - PLEASE READ

Dear Property Owner/Manager:

In an effort to reduce the amount of future service repairs within the street segments listed above that are to be paved this summer, the City is offering a service line repair program as a component of the above referenced project. If you have experienced any sanitary sewer service, water service or drainage problems, please notify the Engineering Department at 651-480-2334 as soon as possible. We will coordinate with the Public Works Department to have those problems investigated so that if necessary, they can be fixed during the construction project to help you avoid costly repairs in the future. ***If the projects are approved for construction by the City Council, we would like to complete all investigations by the end of April.***

The investigation will be done at no cost to you, and will include a video inspection of your sanitary sewer service line. Public Works personnel will need to have access to a cleanout on the service line. This cleanout is typically located in the basement or crawl space. If you request an inspection, you will be contacted to arrange a time at your convenience.

If the investigation identifies a defect with your service line and that defect is located within the City Right-of-Way, the replacement or repair will be added to the project contract and will be done in conjunction with the street repair work this summer at no cost to you. If the investigation identifies a defect with your service line and that defect is located outside of the City Right-of-Way (on private property), you may choose to have that portion of the service line repaired or replaced at your cost and on your schedule.

If you have any questions, please contact the Engineering Department at 651-480-2334.

Sincerely,

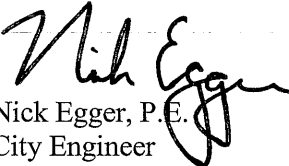
Nick Egger, P.E.
City Engineer

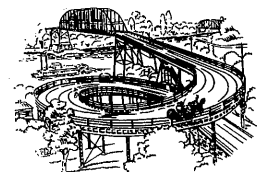

Hastings on the Mississippi

2011 Infrastructure Improvements
Whispering Lane, Whispering Court, & North Frontage Road
 Updated 3/10/2011

Proposed Assessment Rates

\$43.20/Frontage Foot for Standard Property Types - Existing Curb & Gutter

\$60.00/Frontage Foot for Standard Property Types - Full reconstruction

\$900.00/Unit for Condominium/High Density Residential

\$1350.00/Unit for Medium Density Residential Property

<i>Property Address</i>	<i>Proposed Assessment Amount</i>
400 WHISPERING LN	\$1,350.00
402 WHISPERING LN	\$1,350.00
404 WHISPERING LN	\$1,350.00
406 WHISPERING LN	\$1,350.00
401 WHISPERING LN	\$1,350.00
403 WHISPERING LN	\$1,350.00
405 WHISPERING LN	\$1,350.00
407 WHISPERING LN	\$1,350.00
409 WHISPERING LN	\$1,350.00
411 WHISPERING LN	\$1,350.00
501 WHISPERING LN	\$1,350.00
503 WHISPERING LN	\$1,350.00
505 WHISPERING LN	\$1,350.00
507 WHISPERING LN	\$1,350.00
509 WHISPERING LN	\$1,350.00
511 WHISPERING LN	\$1,350.00
540 WHISPERING LN (4 units)	\$5,400.00
560 WHISPERING LN (4 units)	\$5,400.00
567 HIDDEN LN (ACCESS FROM WHISPERING LANE)	\$1,350.00
570 WHISPERING LN 101	\$900.00
570 WHISPERING LN 102	\$900.00
570 WHISPERING LN 103	\$900.00
570 WHISPERING LN 104	\$900.00
570 WHISPERING LN 105	\$900.00
570 WHISPERING LN 106	\$900.00
570 WHISPERING LN 107	\$900.00
570 WHISPERING LN 108	\$900.00
570 WHISPERING LN 201	\$900.00
570 WHISPERING LN 202	\$900.00
570 WHISPERING LN 203	\$900.00
570 WHISPERING LN 204	\$900.00
570 WHISPERING LN 205	\$900.00
570 WHISPERING LN 206	\$900.00
570 WHISPERING LN 207	\$900.00
570 WHISPERING LN 208	\$900.00
570 WHISPERING LN 301	\$900.00
570 WHISPERING LN 302	\$900.00
570 WHISPERING LN 303	\$900.00
570 WHISPERING LN 304	\$900.00
570 WHISPERING LN 305	\$900.00
570 WHISPERING LN 306	\$900.00
570 WHISPERING LN 307	\$900.00
570 WHISPERING LN 308	\$900.00
571 HIDDEN LN (ACCESS FROM WHISPERING LANE)	\$1,350.00
575 HIDDEN LN (ACCESS FROM WHISPERING LANE)	\$1,350.00
579 HIDDEN LN (ACCESS FROM WHISPERING LANE)	\$1,350.00
583 HIDDEN LN (ACCESS FROM WHISPERING LANE)	\$1,350.00
587 HIDDEN LN (ACCESS FROM WHISPERING LANE)	\$1,350.00
591 HIDDEN LN (ACCESS FROM WHISPERING LANE)	\$1,350.00
595 HIDDEN LN (ACCESS FROM WHISPERING LANE)	\$1,350.00
615 WHISPERING LN	\$1,350.00
619 WHISPERING LN	\$1,350.00
625 WHISPERING LN	\$1,350.00
629 WHISPERING LN	\$1,350.00
635 WHISPERING LN	\$1,350.00
639 WHISPERING LN	\$1,350.00
645 WHISPERING LN	\$1,350.00
649 WHISPERING LN	\$1,350.00
650 PLEASANT DR (4 units)	\$5,400.00
1450 WHISPERING CT (4 units)	\$5,400.00
1460 WHISPERING CT (4 units)	\$5,400.00
1465 WHISPERING CT (4 units)	\$5,400.00
1470 WHISPERING CT (4 units)	\$5,400.00
1475 WHISPERING CT (4 units)	\$5,400.00
1484 WHISPERING CT (4 units)	\$5,400.00
LOT AT WHISPERING LANE & PLEASANT (DAKOTA COUNTY)	\$11,750.40
PROPERTY AT SW CORNER OF PLEASANT & NFR (CITY OF HASTINGS)	\$2,343.60

GRAND TOTAL

\$127,494.00

CITY OF HASTINGS ENGINEERING DEPARTMENT

CITY PROJECT 2011-1 2011 INFRASTRUCTURE IMPROVEMENTS

LEGEND		
UTILITIES AND TOPOGRAPHIC FEATURES		
EXISTING NTS	FEATURE	PROPOSED NTS
	CATCH BASIN (2 x 3)	
	CATCH BASIN (ROUND)	
	MANHOLE (STORM)	
	STORM SEWER	
	FLARED END SECTION	
	MANHOLE (SANITARY)	
	SANITARY SEWER	
	CURB STOP	
	FIRE HYDRANT	
	GATE VALVE (WATER)	
	WATER	
	CURB	
	CURB CUT	
	RETAINING WALL	
	CONCRETE DRIVEWAY	
	CONCRETE SIDEWALK	
	ROW & PROP LINE	
	EASEMENT LINE	
	ELECTRIC (UNDERGROUND)	
	GAS	
	OVERHEAD UTILITY	
	TELEPHONE (UNDERGROUND)	
	CABLE TV (UNDERGROUND)	
	FENCE	
	CONSTRUCTION LIMITS	
	BITUMINOUS PAVEMENT	
	CONCRETE PAVEMENT	
	POWER POLE WITH ANCHOR	
	SOIL BORING LOCATION	
	TREE (DECIDUOUS)	
	TREE (CONIFEROUS)	
	SHRUB	
	TREE LINE	
	UTILITY CROSSING (PROFILE)	
	LIGHT POLE	
	MAILBOX	

- ### NOTES
1. THE 2005 EDITION OF THE MINNESOTA DEPARTMENT OF TRANSPORTATION "STANDARD SPECIFICATIONS FOR CONSTRUCTION" AND THE CITY OF HASTINGS "STANDARD SPECIFICATIONS" FOR CONSTRUCTION REV. 2007 SHALL GOVERN
 2. THE SUBSURFACE UTILITY INFORMATION IN THIS PLAN IS UTILITY QUALITY LEVEL "C". THIS UTILITY QUALITY LEVEL WAS DETERMINED ACCORDING TO THE GUIDELINES OF CI/ASCE 38-02, ENTITLED "STANDARD GUIDELINES FOR THE COLLECTION AND DEPICTION OF EXISTING SUBSURFACE UTILITY DATA."
 3. PRIOR TO DIGGING, IT IS REQUIRED BY LAW TO CALL GOPHER STATE ONE CALL FOR UTILITY LOCATIONS 651-454-0002
 4. IT SHALL BE THE CONTRACTOR'S RESPONSIBILITY TO NOTIFY APPROPRIATE UTILITY COMPANIES DUE TO CONFLICTS BEFORE OR DURING CONSTRUCTION. THE CITY SHALL NOT BE HELD LIABLE
 5. ALL TRAFFIC CONTROL DEVICES AND SIGNING SHALL CONFORM TO THE LATEST EDITION OF THE MINNESOTA MANUAL ON UNIFORM TRAFFIC CONTROL DEVICES (MMUTCD), INCLUDING THE FIELD MANUAL FOR TEMPORARY TRAFFIC CONTROL ZONE LAYOUTS

DRAWING SCALE

	HORIZONTAL	VERTICAL
PLANS		
PROFILES		
CROSS SECTIONS		

CONTENTS

GENERAL SHEETS			
SHEET	DESCRIPTION		
1	TITLE SHEET		
2	ESTIMATED QUANTITIES 1 OF 2		
3	ESTIMATED QUANTITIES 2 OF 2		
4	DETAILS		
5	TYPICAL SECTIONS 1 OF 5		
6	TYPICAL SECTIONS 2 OF 5		
7	TYPICAL SECTIONS 3 OF 5		
8	TYPICAL SECTIONS 4 OF 5		
9	TYPICAL SECTIONS 5 OF 5		
10	RETAINING WALL DETAILS 1 OF 5		
11	RETAINING WALL DETAILS 2 OF 5		
12	RETAINING WALL DETAILS 3 OF 5		
13	RETAINING WALL DETAILS 4 OF 5		
14	RETAINING WALL DETAILS 5 OF 5		
15	STORM WATER POLLUTION PREVENTION PLAN		
STREET PLAN & PROFILE SHEETS			
AREA 1			
16	12TH STREET PLAN & PROFILE		
17	BLUEBERRY LN PLAN & PROFILE		
18	BLUEBERRY CT & ROSEMARY CT PLAN & PROFILE		
19	14TH ST PLAN & PROFILE - PLEASANT DR TO WESTVIEW DR		
20	14TH ST PLAN & PROFILE - WESTVIEW DR TO W OF PARK LN		
21	14TH ST PLAN & PROFILE - W OF PARK LN TO E OF LYN WAY		
22	14TH ST PLAN & PROFILE - E OF LYN WAY TO PINE ST		
23	HONEYSUCKLE LN PLAN & PROFILE - WEST END TO SUN VALLEY DR		
24	HONEYSUCKLE LN PLAN & PROFILE - SUN VALLEY DR TO 12TH ST		
25	SUN VALLEY DRIVE PLAN & PROFILE		
26	HILLSIDE ST PLAN & PROFILE - 15TH ST TO 14TH ST		
27	VIEW CT & HILLSIDE CT PLAN & PROFILE		
28	PRAIRIE ST PLAN & PROFILE - 15TH ST TO 14TH ST		
AREA 2 (ALTERNATE)			
29	WHISPERING LN PLAN & PROFILE - PLEASANT DR TO 4TH ST		
30	WHISPERING CT & NORTH FRONTAGE RD PLAN & PROFILE		
AREAS 3 & 4 (ALTERNATE)			
31	11TH ST PLAN & PROFILE - VERMILLION ST TO TYLER ST		
32	15TH ST, 16TH ST & FLORENCE ST PLAN & PROFILE		
33	MCMAMARA AVE & SUMNER AVE PLAN & PROFILE		
34	BAILLY ST PLAN & PROFILE - 17TH ST TO 15TH ST		
35	17TH ST PLAN & PROFILE - RAMSEY ST TO SUMNER AVE		
CROSS SECTION SHEETS			
SHT	DESCRIPTION	SHT	DESCRIPTION
36	12TH ST W XX+XX TO XX+XX	71	SUN VALLEY DR XX+XX TO XX+XX
37	12TH ST W XX+XX TO XX+XX	72	SUN VALLEY DR XX+XX TO XX+XX
38	12TH ST W XX+XX TO XX+XX	73	HILLSIDE ST XX+XX TO XX+XX
39	12TH ST W XX+XX TO XX+XX	74	HILLSIDE ST XX+XX TO XX+XX
40	12TH ST W XX+XX TO XX+XX	75	HILLSIDE ST XX+XX TO XX+XX
41	BLUEBERRY LN XX+XX TO XX+XX	76	VIEW CT XX+XX TO XX+XX
42	BLUEBERRY LN XX+XX TO XX+XX	77	VIEW CT XX+XX TO XX+XX
43	BLUEBERRY LN XX+XX TO XX+XX	78	HILLSIDE CT XX+XX TO XX+XX
44	BLUEBERRY CT XX+XX TO XX+XX	79	HILLSIDE CT XX+XX TO XX+XX
45	14TH ST W XX+XX TO XX+XX	80	PRAIRIE ST XX+XX TO XX+XX
46	14TH ST W XX+XX TO XX+XX	81	WHISPERING LN XX+XX TO XX+XX
47	14TH ST W XX+XX TO XX+XX	82	WHISPERING LN XX+XX TO XX+XX
48	14TH ST W XX+XX TO XX+XX	83	WHISPERING LN XX+XX TO XX+XX
49	14TH ST W XX+XX TO XX+XX	84	WHISPERING CT XX+XX TO XX+XX
50	14TH ST W XX+XX TO XX+XX	85	WHISPERING CT XX+XX TO XX+XX
51	14TH ST W XX+XX TO XX+XX	86	N FRONTAGE RD XX+XX TO XX+XX
52	14TH ST W XX+XX TO XX+XX	87	11TH ST E XX+XX TO XX+XX
53	14TH ST W XX+XX TO XX+XX	88	11TH ST E XX+XX TO XX+XX
54	14TH ST W XX+XX TO XX+XX	89	11TH ST E XX+XX TO XX+XX
55	14TH ST W XX+XX TO XX+XX	90	15TH ST E XX+XX TO XX+XX
56	14TH ST W XX+XX TO XX+XX	91	16TH ST E XX+XX TO XX+XX
57	14TH ST W XX+XX TO XX+XX	92	FLORENCE ST XX+XX TO XX+XX
58	14TH ST W XX+XX TO XX+XX	93	MCMAMARA AVE XX+XX TO XX+XX
59	14TH ST W XX+XX TO XX+XX	94	MCMAMARA AVE XX+XX TO XX+XX
60	14TH ST W XX+XX TO XX+XX	95	MCMAMARA AVE XX+XX TO XX+XX
61	14TH ST W XX+XX TO XX+XX	96	SUMNER AVE XX+XX TO XX+XX
62	ROSEMARY CT XX+XX TO XX+XX	97	BAILLY ST XX+XX TO XX+XX
63	HONEYSUCKLE CT XX+XX TO XX+XX	98	BAILLY ST XX+XX TO XX+XX
64	HONEYSUCKLE CT XX+XX TO XX+XX	99	BAILLY ST XX+XX TO XX+XX
65	HONEYSUCKLE LN XX+XX TO XX+XX	100	BAILLY ST XX+XX TO XX+XX
66	HONEYSUCKLE LN XX+XX TO XX+XX	101	17TH ST E XX+XX TO XX+XX
67	HONEYSUCKLE LN XX+XX TO XX+XX	102	17TH ST E XX+XX TO XX+XX
68	HONEYSUCKLE LN XX+XX TO XX+XX	103	17TH ST E XX+XX TO XX+XX
69	HONEYSUCKLE LN XX+XX TO XX+XX	104	17TH ST E XX+XX TO XX+XX
70	HONEYSUCKLE LN XX+XX TO XX+XX	105	17TH ST E XX+XX TO XX+XX

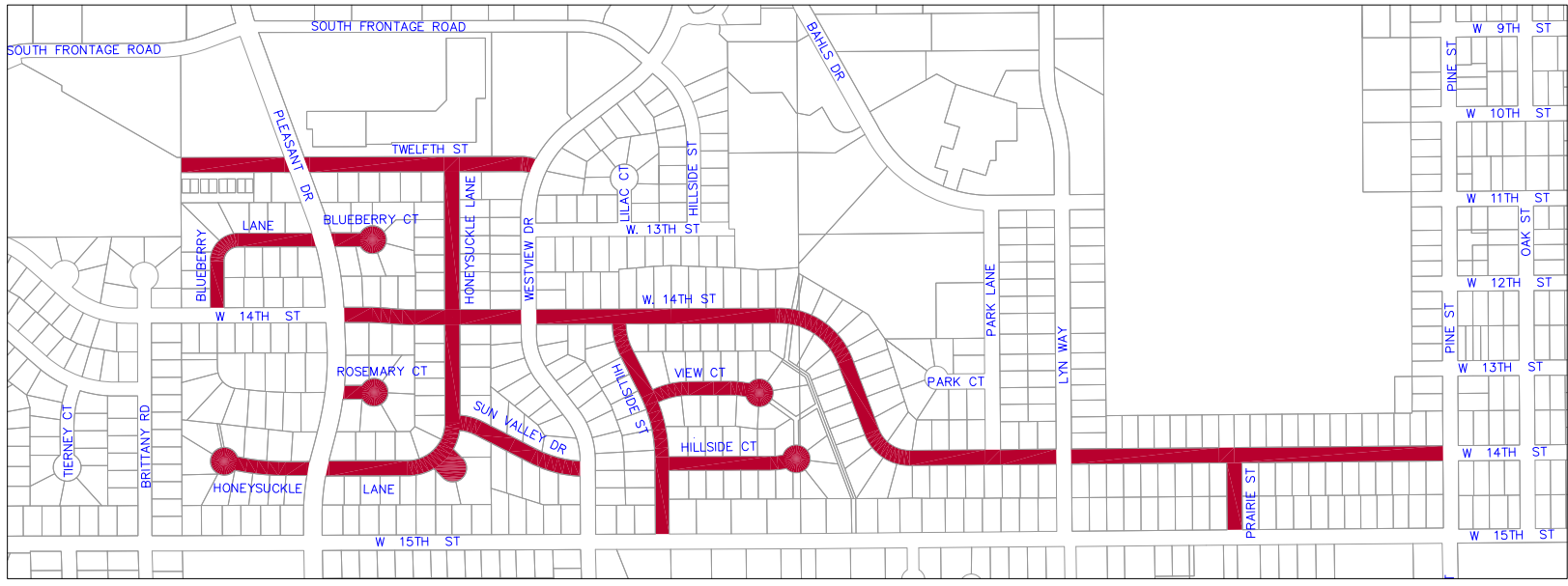

AREA 1

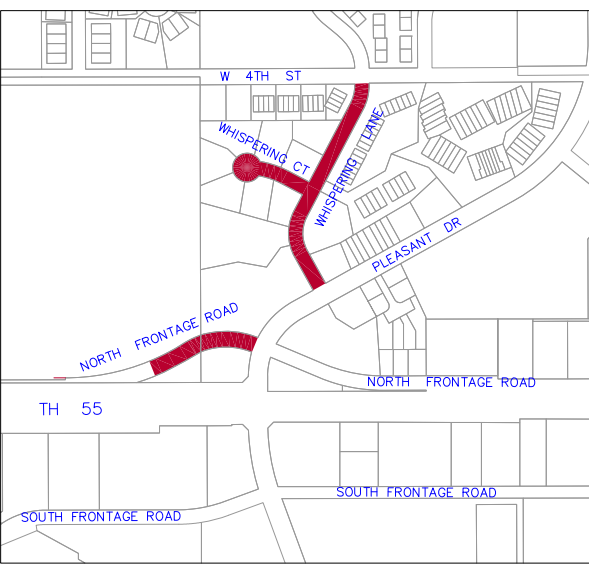

AREA 2
(ALTERNATE)

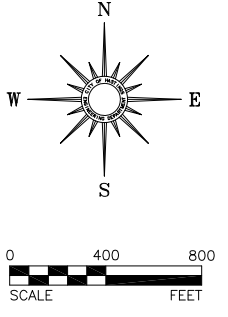

VICINITY MAPS

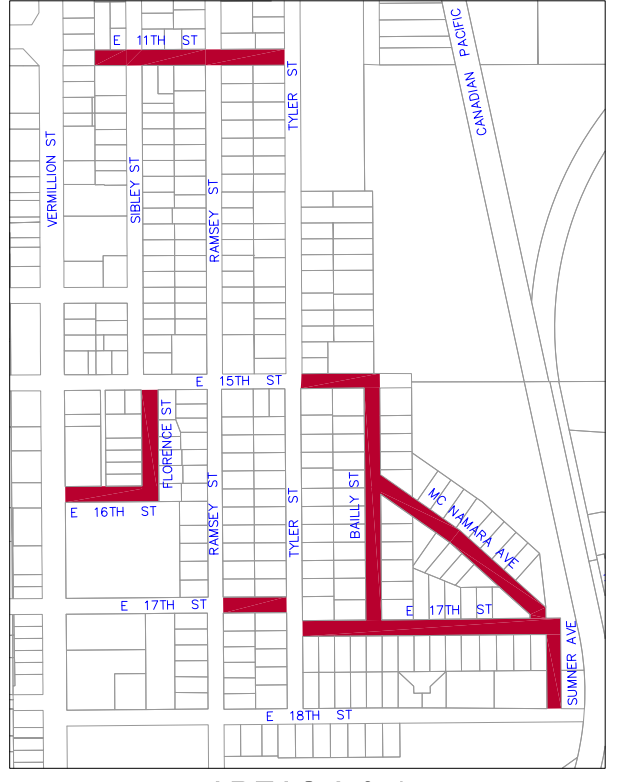

AREAS 3 & 4
(ALTERNATE)

PRELIMINARY NOT FOR CONSTRUCTION

REV.	BY	DATE

I HEREBY CERTIFY THAT THIS PLAN WAS PREPARED BY ME OR UNDER MY DIRECT SUPERVISION AND THAT I AM A DULY LICENSED PROFESSIONAL ENGINEER UNDER THE LAWS OF THE STATE OF MINNESOTA.

NICHOLAS A. EGGER, P.E.
45834 DATE ??/??/??

DESIGNED: DWC
DRAWN: DWC
CHECKED: NAE

CITY OF HASTINGS
101 4TH STREET EAST
HASTINGS, MN 55033

CITY PROJECT 2011-1
2011 INFRASTRUCTURE IMPROVEMENTS

TITLE SHEET

SHEET 1 OF ?

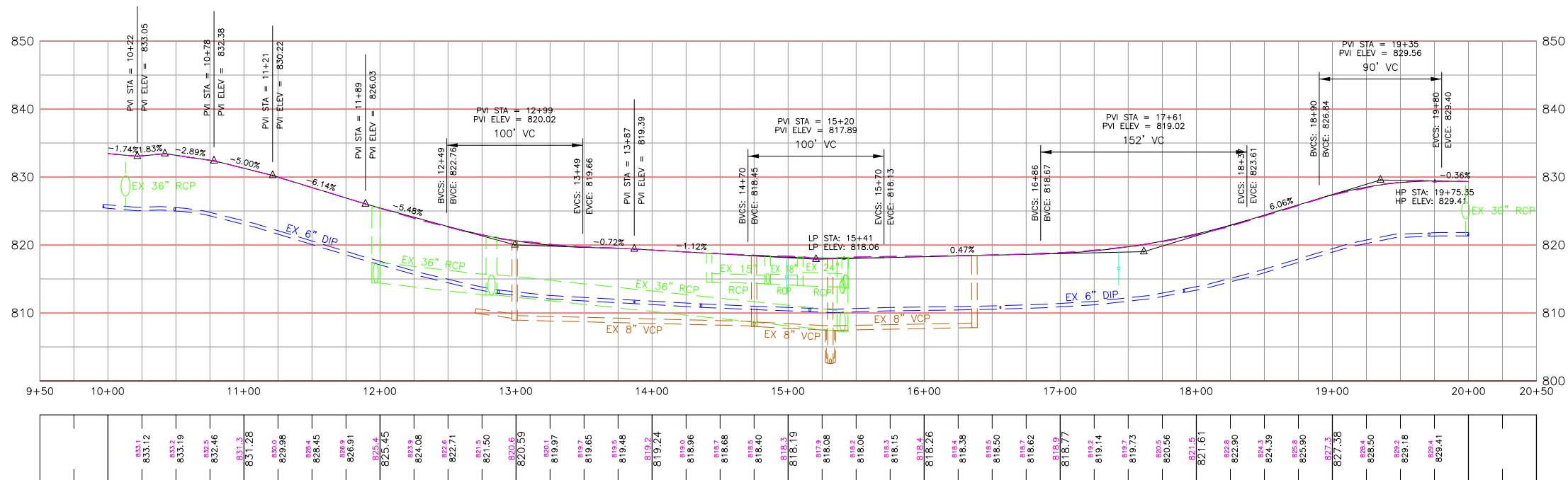
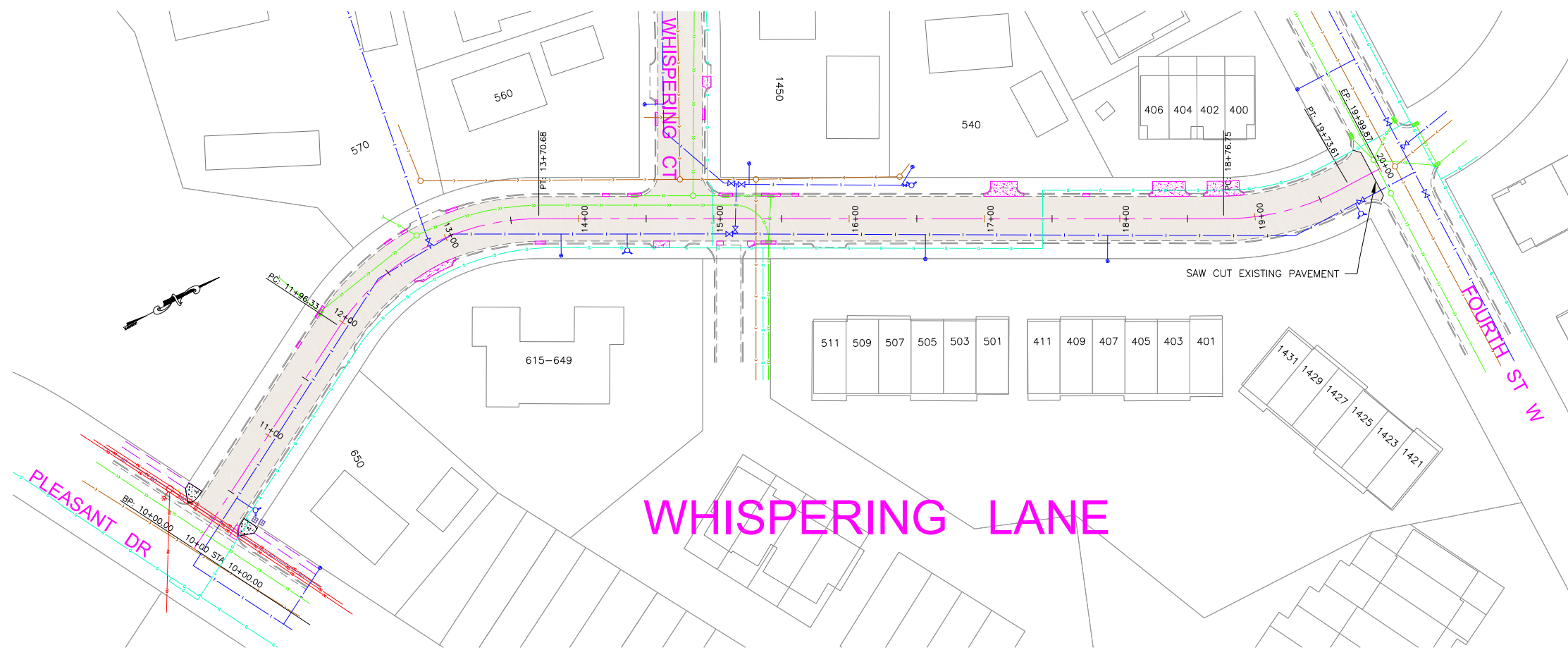

PRELIMINARY NOT FOR CONSTRUCTION

REV.	BY	DATE

I HEREBY CERTIFY THAT THIS PLAN WAS PREPARED BY ME OR UNDER MY DIRECT SUPERVISION AND THAT I AM A DULY LICENSED PROFESSIONAL ENGINEER UNDER THE LAWS OF THE STATE OF MINNESOTA.

NICHOLAS A. EGGER, P.E.
 LIC. NO. 45834 DATE ??/??/????

DESIGNED
 DWG
 DRAWN
 DWG
 CHECKED
 NAE



CITY OF HASTINGS
 101 4TH STREET EAST
 HASTINGS, MN 55033

CITY PROJECT 2011-1
 2011 INFRASTRUCTURE IMPROVEMENTS
 WHISPERING LANE PLAN & PROFILE

SHEET
 ?
 OF
 ?

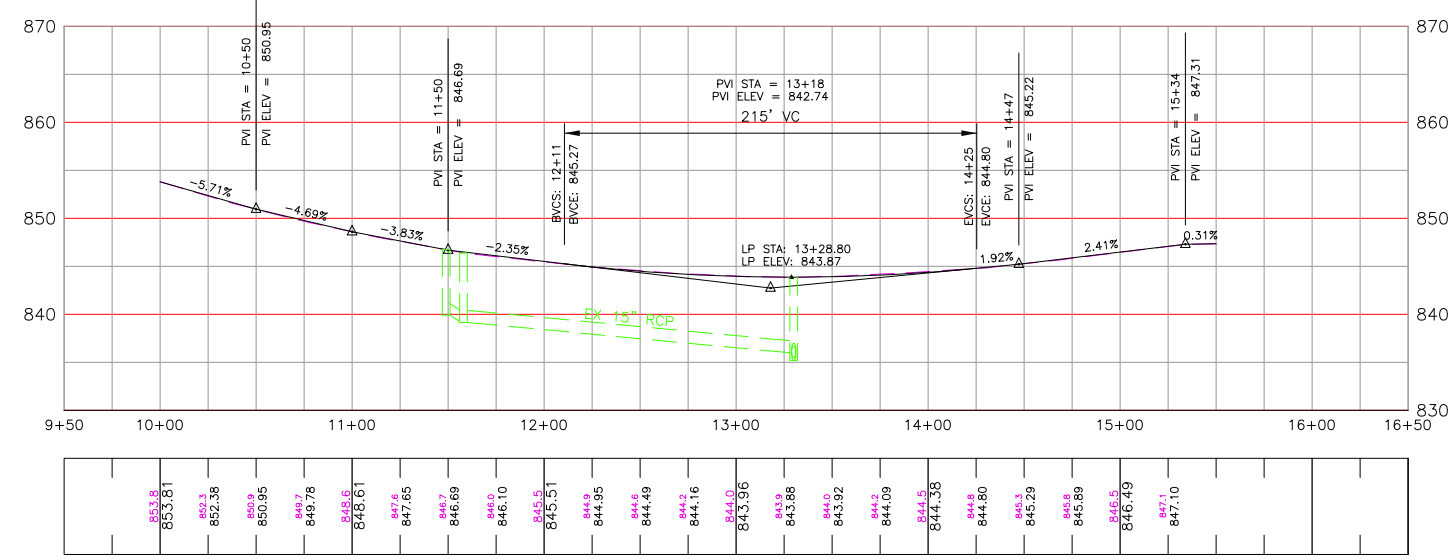
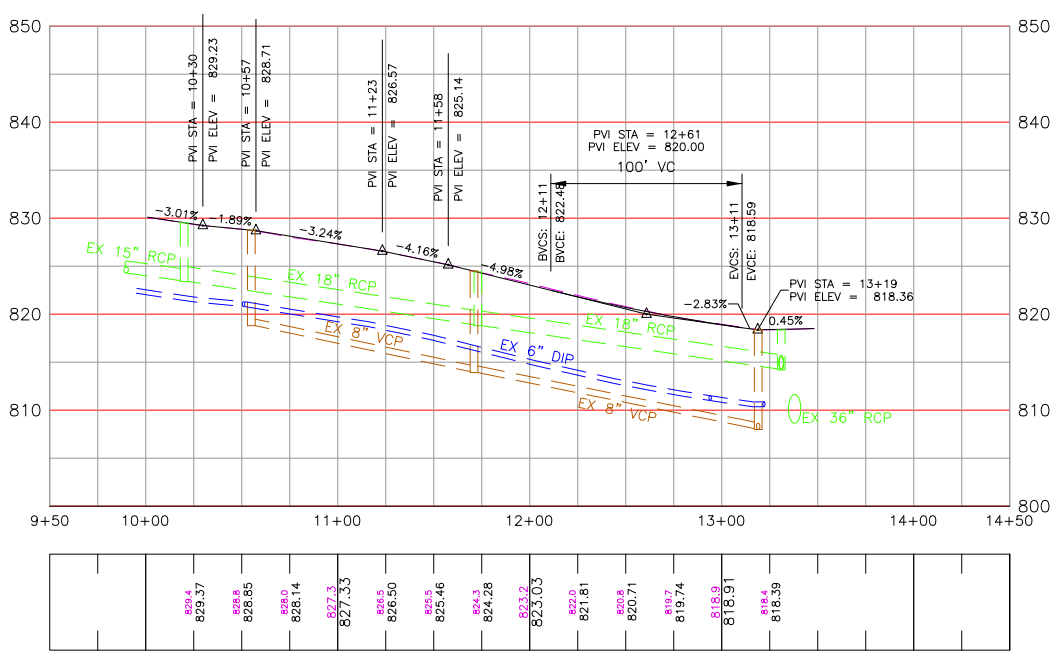
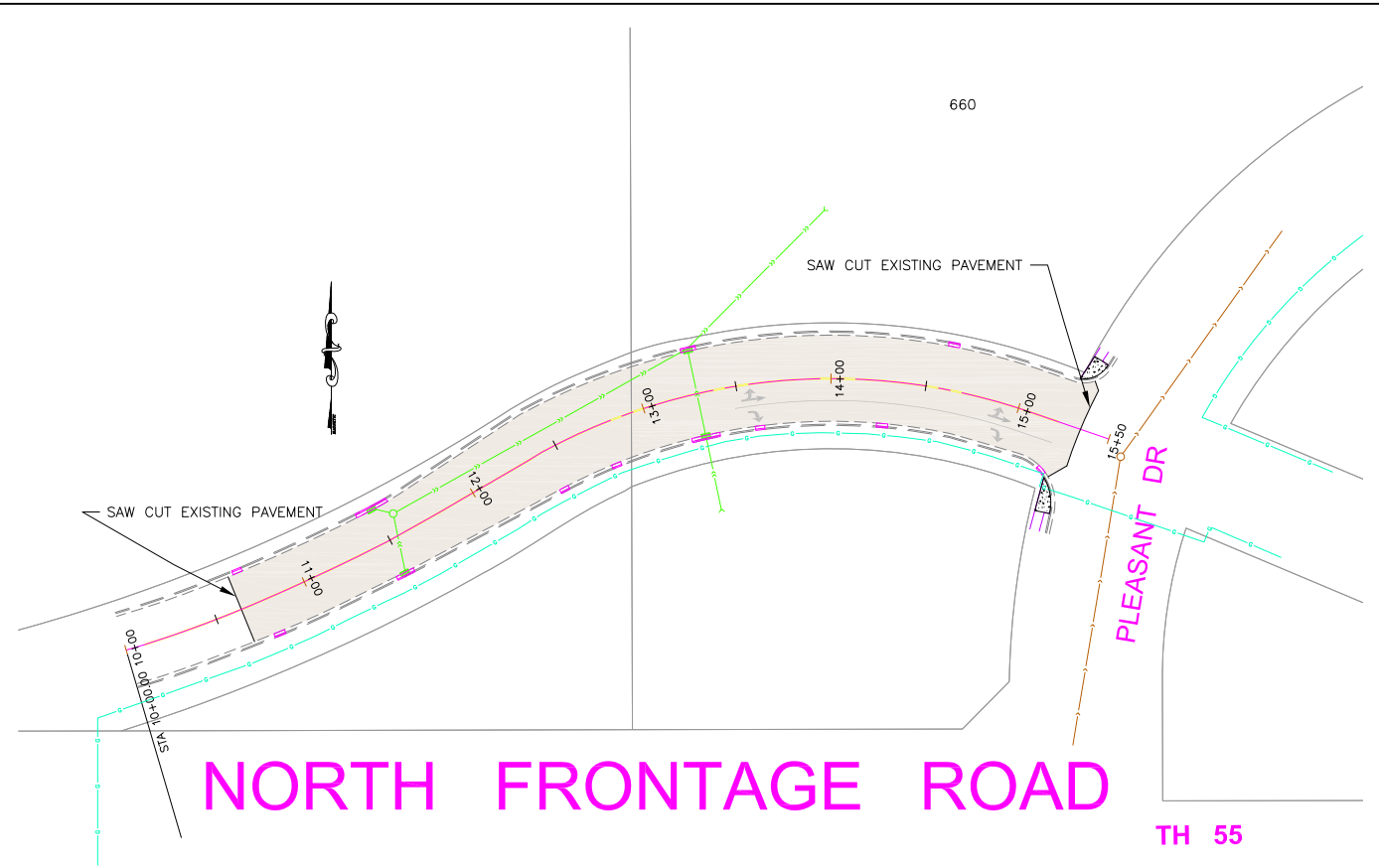
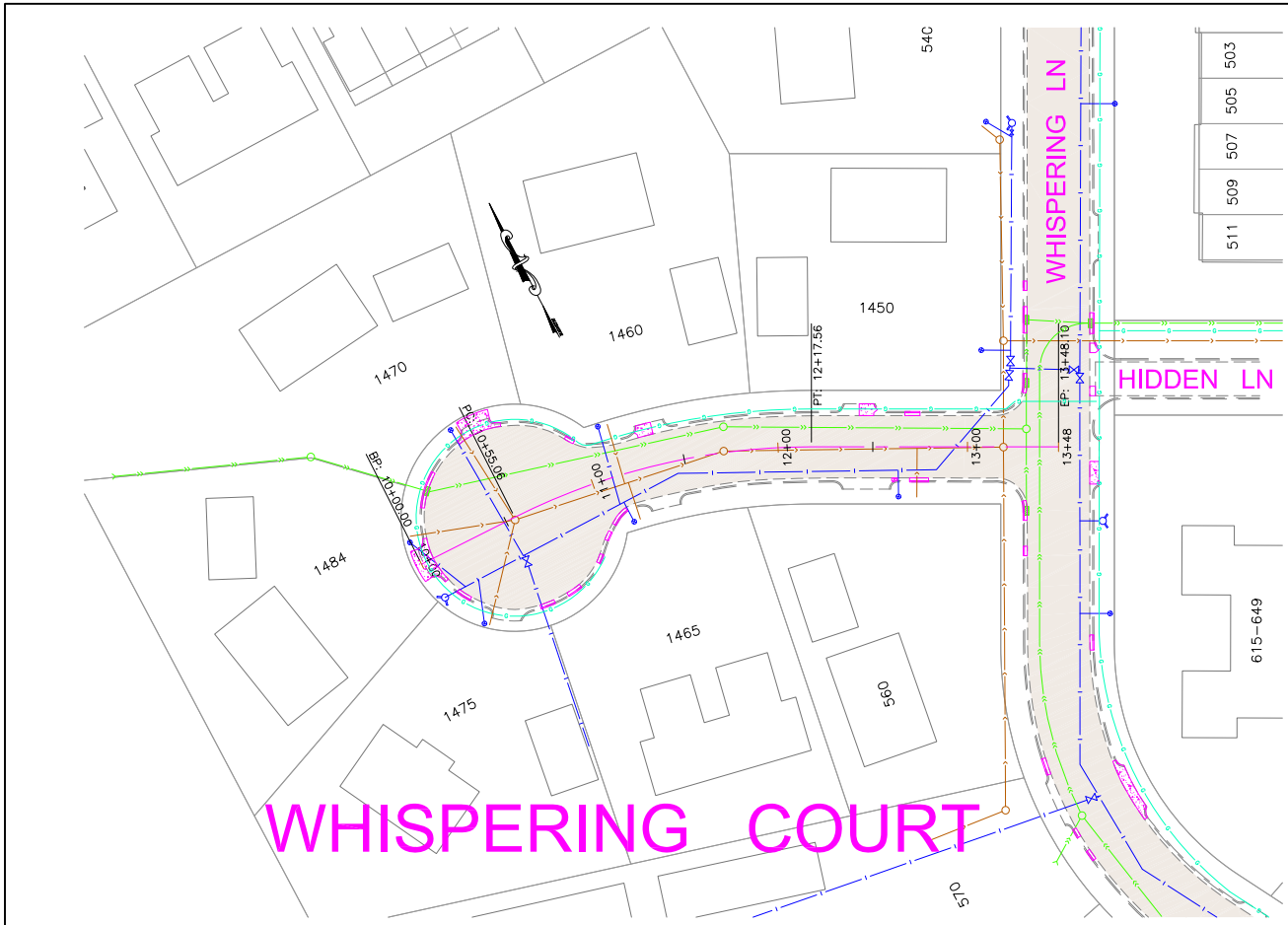

PRELIMINARY NOT FOR CONSTRUCTION

REV. BY DATE
 I HEREBY CERTIFY THAT THIS PLAN WAS PREPARED BY ME OR UNDER MY DIRECT SUPERVISION AND THAT I AM A DULY LICENSED PROFESSIONAL ENGINEER UNDER THE LAWS OF THE STATE OF MINNESOTA.
 NICHOLAS A. EGGER, P.E.
 LIC. NO. 45834 DATE ??/??/????

DESIGNED: DWC
 DRAWN: DWC
 CHECKED: NAE



CITY OF HASTINGS
 101 4TH STREET EAST
 HASTINGS, MN 55033

CITY PROJECT 2011-1
 2011 INFRASTRUCTURE IMPROVEMENTS
 WHISPERING CT & NORTH FRONTAGE RD - PLAN & PROFILE

SHEET ? OF ?